

ROADMAP TO BUILD A HOME FOR YOUR EVENT

HOUSE OF EVENTS HOME OF YOUR INDUSTRY



RAI Amsterdam is not just any place. It's a home for your event to thrive - the perfect place to connect, innovate, create impact and have a great time.

Our house is your home.
Welcome home. Explore the house.





PLAN YOUR ROAD TO SUCCESS

UNLOCK YOUR EVENT AND ENTER A WORLD OF POSSIBILITIES. RAI HOLDS THE KEY – JUST MAKE YOURSELF AT HOME.

RAI Amsterdam has a rich history. Founded in 1893 as a bicycle industry association, RAI has grown in just over a century to become a leading international trade event and conference organisation. Now, 130 years later, RAI remains a premier networking organisation and platform for key industries. With over 600 events a year, our portfolio still spans the Logistics & Smart Mobility sector and our expertise has broadened to serve and connect the world's leading industries.

Today, our mission is the same: to bring together people, ideas and organisations to share knowledge, stimulate innovation and support economic growth. RAI Amsterdam has also committed itself to the sustainable development of people and communities, the economy, and the environment.



OUR WELL-CONNECTED VENUE OFFERS 116,200 SQM OF HIGHLY FLEXIBLE MEETING, EXHIBITION, BALLROOM AND PLENARY SPACE - GIVING YOU A HEAD START ON YOUR EVENT PLANNING.

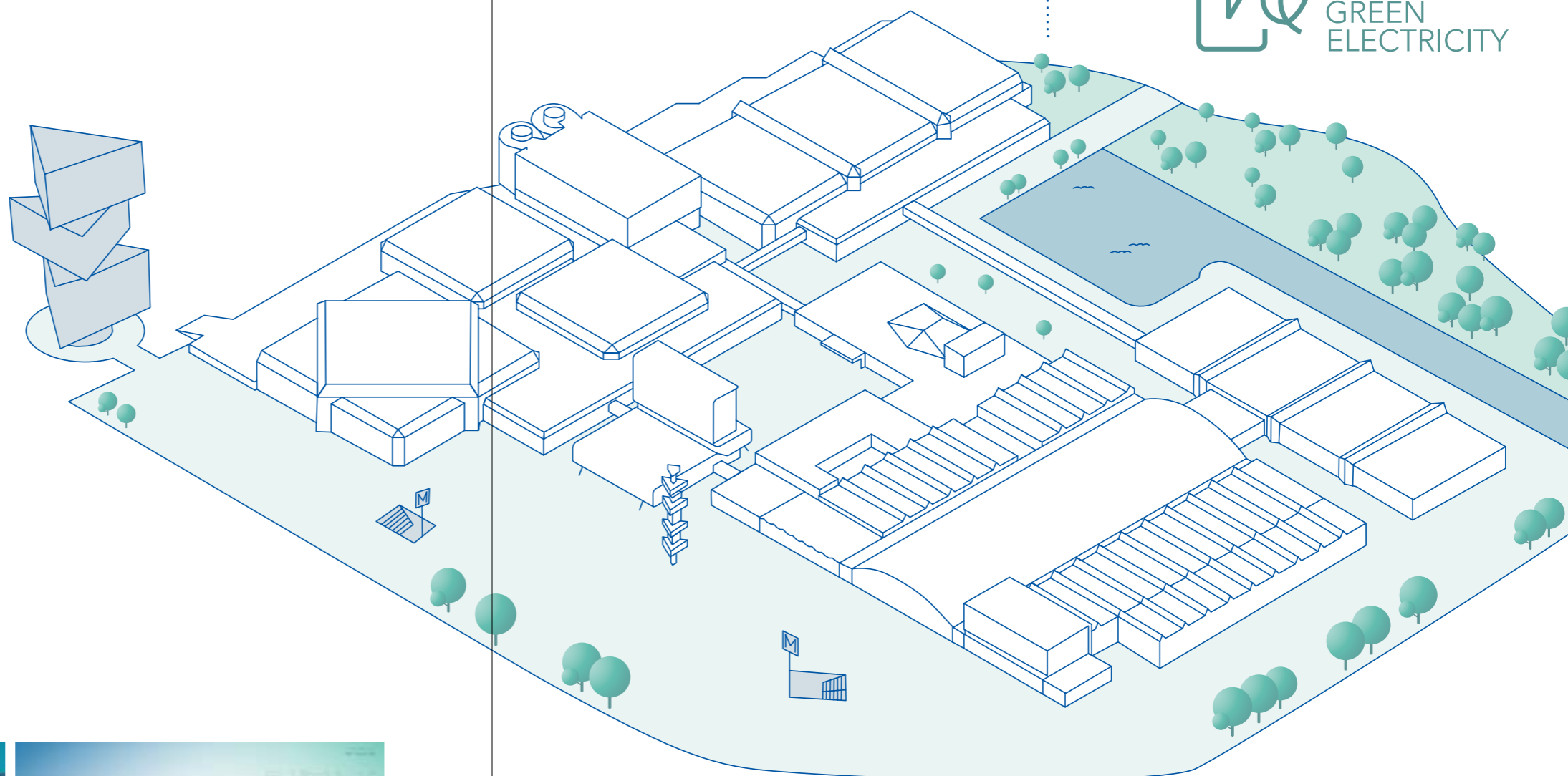

RAI AMSTERDAM IS THE GATEWAY TO THE CITY WHERE THE WORLD MEETS AMSTERDAM AND AMSTERDAM MEETS THE WORLD



12 MULTI-FUNCTIONAL HALLS

1 BALLROOM

3 INTERLINKED
CONFERENCE CENTRES

70 CONFERENCE &
MEETING ROOMS

2 AUDITORIUMS

5 RESTAURANTS

HARBOUR & URBAN BEACH



THE PERFECT HOME FOR YOUR EVENT

Together, we have the ability to spark your event and take your business to the next level, ensuring that everything is in place to exceed expectations. Our company and preferred partners respect and understand your mission and are therefore committed to providing you with the expert solutions and outstanding service you need.



OVERVIEW HALLS

	M ²	SQR	☀️	👤	☀️
Hall 1	15,000	161,459	6,900	10,000	•
Hall 1 + Balcony	18,240	196,334			•
Hall 2	4,060	43,701	1,840	4,000	•
Hall 3	3,920	42,195	1,600	4,000	•
Hall 4 > Amtrium	540	5,812	264	500	•
Hall 5	11,395	122,654	8,390	6,740	•
Hall 6	1,025	11,033			•
Hall 7	10,460	112,590	4,040	8,000	•
Hall 8	12,600	135,625	4,680	10,000	•
Hall 9	2,845	30,623	2,148	1,500	•
Hall 10	3,970	42,733	1,800	4,000	•
Hall 11	4,165	44,832	1,890	4,000	•
Hall 12	9,035	97,252	3,900	7,500	•
Hall 13 > Ballroom	1,985	21,366	1,070	2,000	•

Figures are guidelines, no rights can be derived from these figures.
 • = daylight available

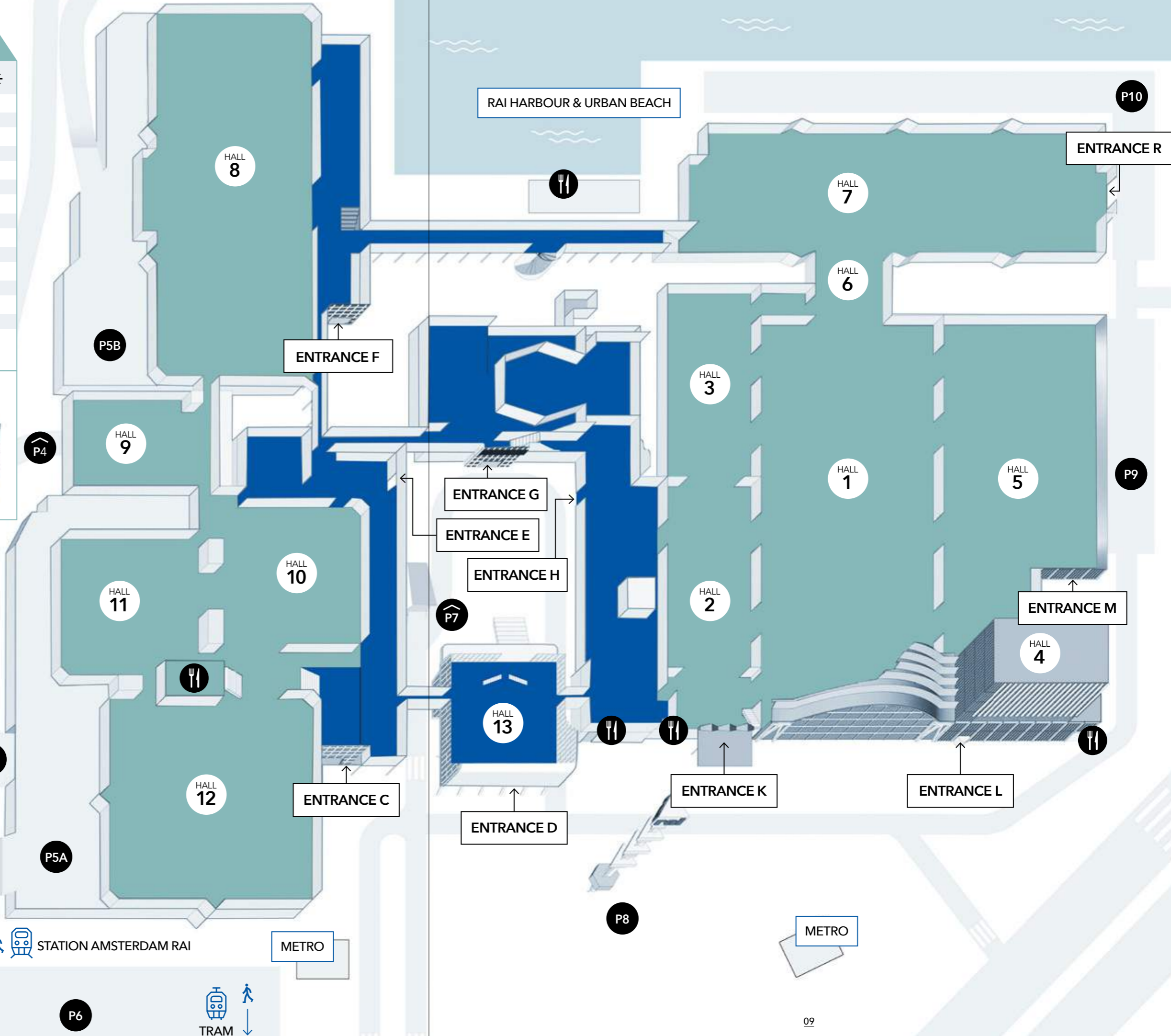
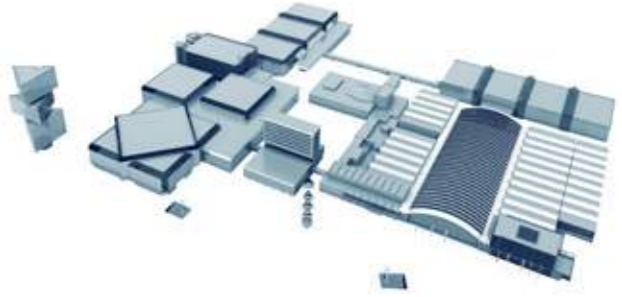

nhow AMSTERDAM RAI HOTEL

← STATION AMSTERDAM RAI

METRO

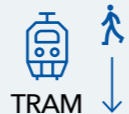

METRO

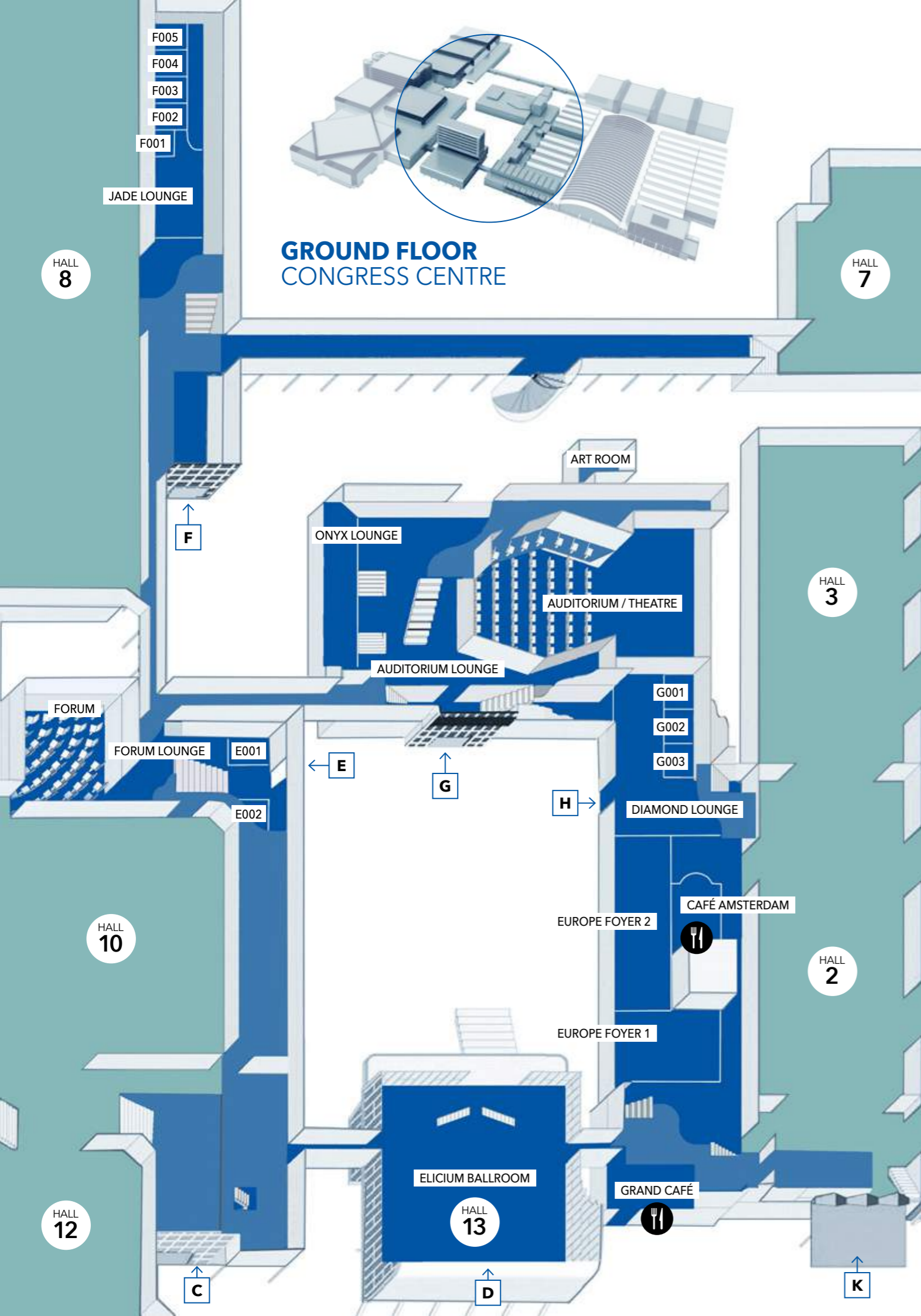

GROUND FLOOR CONGRESS CENTRE & ELICIUM BALLROOM

ENTRANCE D - ELICIUM	[M ²]	[SqM]	⌘	⌘	⌘	⌘	⌘	☀	🍷	☀
Elicium Ballroom	1,985	21,366	1,974	760	1,104	130		1,070		•
Elicium 1	869	9,353	700	288	462	92				•
Elicium 2	1,116	12,013	1,100	432	654	104				•

ENTRANCE E - FORUM CENTRE	[M ²]	[SqM]	⌘	⌘	⌘	⌘	⌘	☀	🍷	☀
E001*	48	517						10		•
E002*	38	409						8		•
Forum	755	8,127	709							•
Forum Lounge	1,120	12,056						390	500	•

ENTRANCE F - PARK CENTRE	[M ²]	[SqM]	⌘	⌘	⌘	⌘	⌘	☀	🍷	☀
F001*	18	194						8		•
F002	90	969	97	40	60	26	32	60		•
F003	90	970	97	40	60	26	32	60		•
F004	90	971	97	40	60	26	32	60		•
F005	90	972	97	40	60	26	32	60		•
F002-F003/F003-F004/F004-F005	180	1,938	176	84	120	40	52	96		•
F002-F004/F003-F005	270	2,906	250	120	180	60	72	136		•
F002-F005	360	3,875	318	160	252	80	92	208		•
Jade Lounge	336	3,616						120	250	•

ENTRANCE G - AUDITORIUM CENTRE	[M ²]	[SqM]	⌘	⌘	⌘	⌘	⌘	⌘	☀	🍷	☀
Onyx lounge	795	8,557							370	500	•
Auditorium Ground Floor + Balcony	1,500	16,146	1,732								•
Auditorium Ground Floor	1,075	11,571	1,248								•
Auditorium Lounge + Upper Lounge	2,660	28,632									•
Auditorium Lounge	1,600	17,222						496	1,250		•
Upper Lounge	1,060	11,410						470	700		•
Dressing Room 1-3	18	194									•
Artist Foyer*	88	947									•
G001	51	548	50	10	36	15	20	30			•
G002	44	474	30	10	24	12	16	20			•
G001-G002	95	1,022	110	32	72	31	36	56			•
G003*	43	463						12			•
Diamond Lounge	745	8,019						240	500		•
Europe Foyer	1,833	19,730						1,030	1,250		•
Europe Foyer 1	1,163	12,518						730	750		•
Europe Foyer 2	670	7,211						410	500		•

RESTAURANTS	[M ²]	[SqM]	☀	🍷	☀
Grand Café	480	4,359			200
Café Amsterdam	245	2,637			80

Figures are guidelines, no rights can be derived from these figures. *Fixed set up. **Only in combination with halls. • Available

1ST FLOOR CONGRESS CENTRE

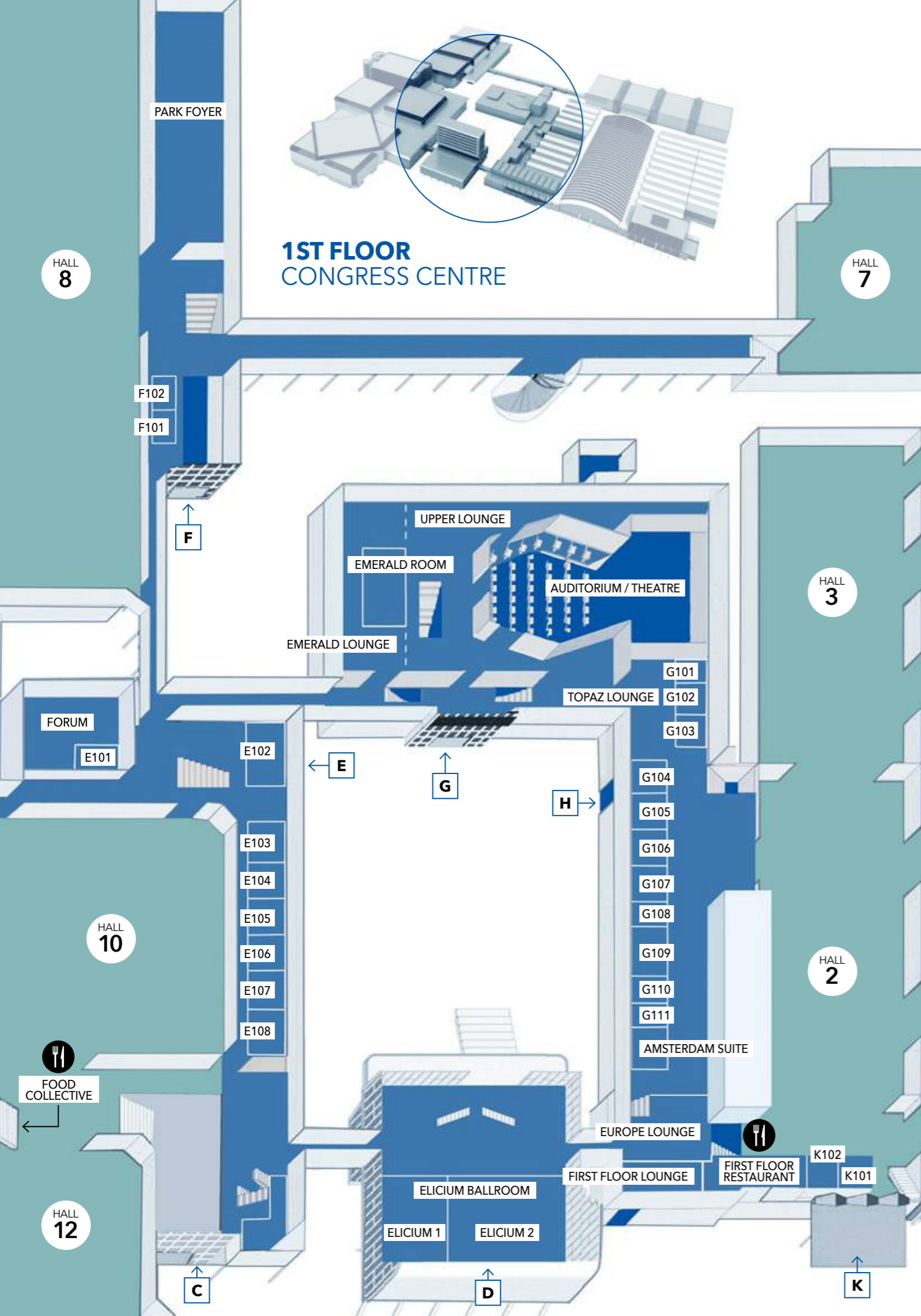

1ST FLOOR CONGRESS CENTRE & ELICIUM BALLROOM

ENTRANCE C	[M ²]	[SqM]	⌘	⌘	⌘	⌘	⌘	⌘	⌘	⌘	⌘
Holland Lounge	310	3,336									•
ENTRANCE D - ELICIUM											
Elicium Ballroom	1,985	21,366	1,974	760	1,104	130		1,070			•
Elicium 1	869	9,353	700	288	462	92					•
Elicium 2	1,116	12,013	1,100	432	654	104					•
ENTRANCE E - FORUM CENTRE											
Ruby Lounge	424	4,564						220	250		•
E101	20	215					14				•
E102	239	2,573	240	102	138	42	60	120			•
E103	120	1,292	128	48	72	29	38	64-80			•
E104	124	1,335	128	48	72	29	38	64-80			•
E105/E106	80	861	70	32	48	22	28	40-50			•
E107	124	1,335	128	48	72	29	38	64-80			•
E108	120	1,292	128	48	72	29	38	64-80			•
E103-E104 or E107-E108***	244	2,626	288	96	138	42	64	140			•
E104-E105 or E106-E107***	204	2,195	216	80	114	40	60	100			•
E105-E106***	160	1,722	178	64	90	34	48	90			•
E103-E104-E105-E106-E107-E108***	648	6,975	704	256	366	98	160	360			•
ENTRANCE F - PARK CENTRE											
Park Foyer	1,600	17,222	1,433								•
F101**	94	1,011					14				•
F102**	44	473					12				•
ENTRANCE G - AUDITORIUM CENTRE											
Auditorium + Balcony	1,500	16,146	1,732								•
Upper Lounge	1,060	11,410						470	700		•
Emerald Room	240	2,583	266	98	168	44	56	130			•
Emerald Lounge	595	6,405						310	280		•
Dressing Room 4-8*	18	194									•
Dressing Room 9*	27	291									•
G101	35	377	24	10	12	16	16				•
G102	125	1,346	154	57	90	26	36	64			•
G103	125	1,346	150	53	90	26	36	64			•
G102-G103	250	2,690	300	114	186	54	64	128			•
Topaz Lounge	495	5,328						190	250		•
G104	120	1,292	120	49	76	30	40	64			•
G105	120	1,292	120	49	76	30	40	64			•
G104-G105/G106-G107	240	2,584	279	110	170	54	68	128			•
G106	120	1,292	120	49	76	30	40	64			•
G107	120	1,292	120	49	76	30	40	64			•
G109	100	1,076	95	42	66	34	36	56			•
G108/G110/G111	45	484	32	18	18	14	16	24			•
Amsterdam Suite*	70	753					22				•
ENTRANCE K											
K101**	80	861					22				•
K102**	80	861					22				•
First Floor Lounge	205	2,207									•
Europe Lounge	282	3,035									•
ENTRANCE R											
R101**	35	376					6*				•
R102**	72	775					12*				•
RESTAURANTS											
First Floor Restaurant	480	5,167					238				•
The Food Collective	640	6,888					220				•

Figures are guidelines, no rights can be derived from these figures. *Fixed Seating. **Only in combination with halls. *** Meeting rooms are flexible to fit your meeting requirements from 70 to 704 persons (flexible walls). • Available



FOSTERING INNOVATION AND GROWTH THROUGH SUSTAINABILITY

RAI AMSTERDAM VISION 2030 - WE'RE COMMITTED TO HOSTING CLIMATE POSITIVE EVENTS

We are committed to addressing the most pressing global challenges of our time, calling on collaborative partnerships, creative thinking, and innovation to balance the three dimensions of sustainable development - economic growth, environmental sustainability, and social inclusion.

RAI Amsterdam's ambition is to switch to circular economy processes and reduce the overall footprint of the events we organise and facilitate. We integrate sustainability into our business strategy to drive innovation by applying new considerations and solutions that shape the way key resources are used in products, systems, and all processes. Which are characterised by smarter production technologies, reusability, recyclability, material longevity, biodegradability, and reduced CO2 emissions.

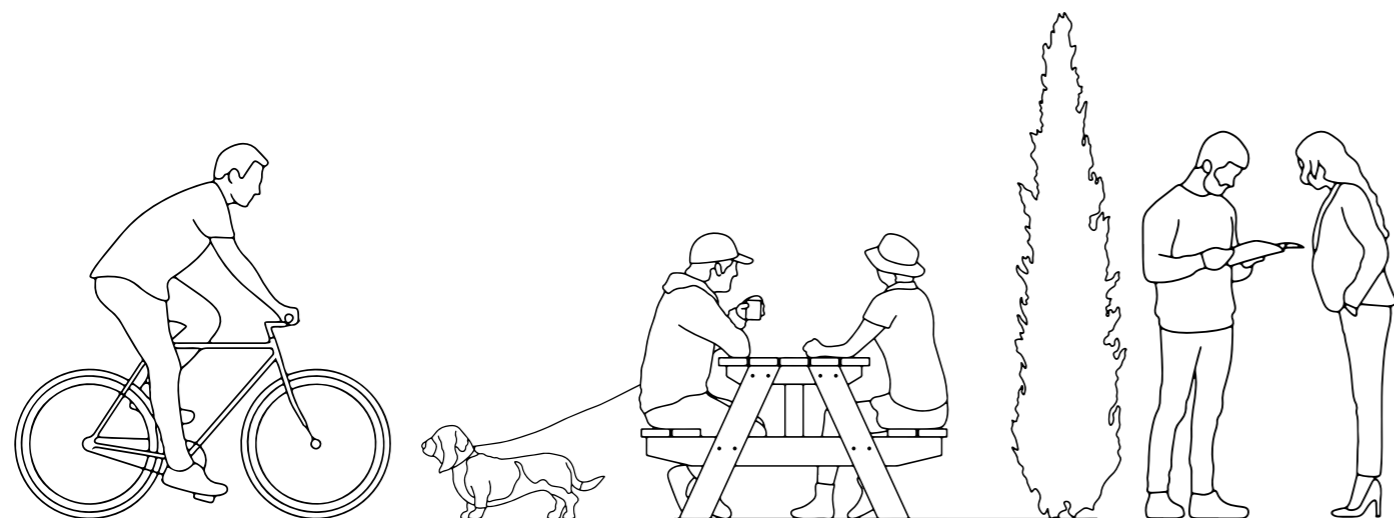

PROMOTING THE CREATION OF EVENTS THAT FOSTER SUSTAINABILITY AND POSITIVE ECONOMIC, SOCIAL, AND ENVIRONMENTAL DEVELOPMENTS

RAI VISION 2030

AN ATTRACTIVE INTERNATIONAL MEETING PLACE FOR EVERYONE - VISITORS TO TRADE FAIRS/EVENTS AND AMSTERDAMMERS

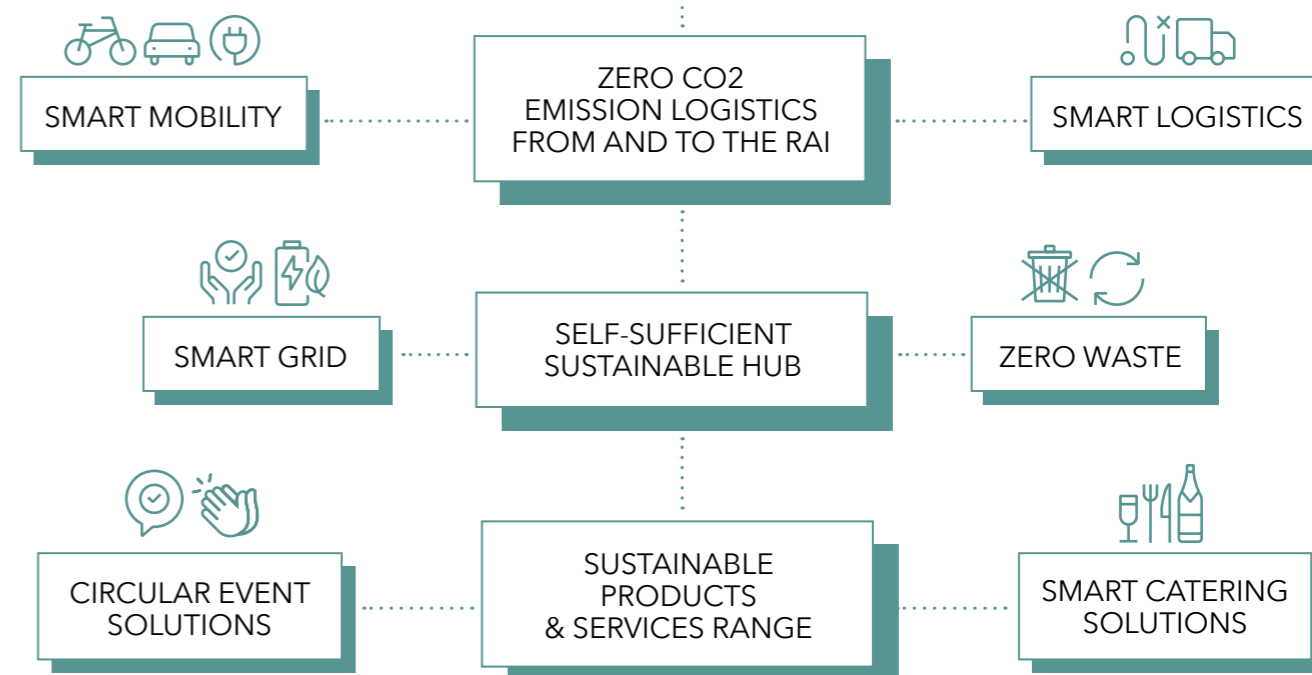

A healthy and sustainable event environment



The perfect place to blend business with leisure

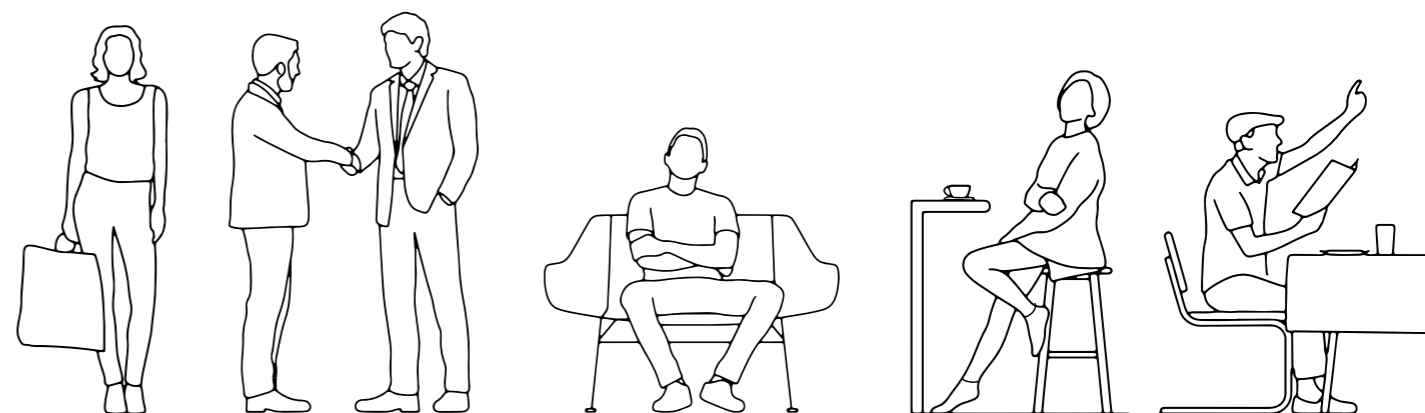

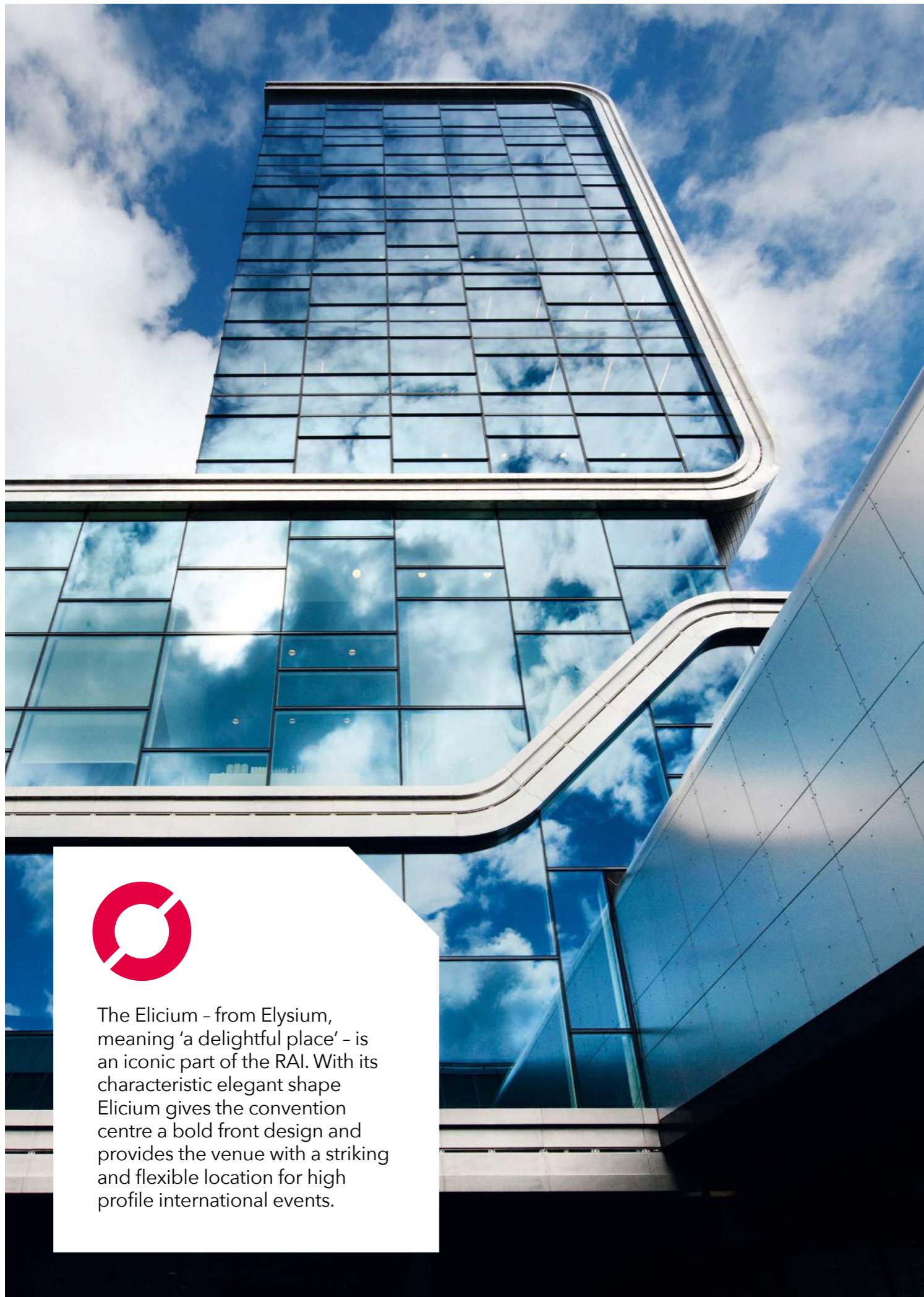

The Elicium - from Elysium, meaning 'a delightful place' - is an iconic part of the RAI. With its characteristic elegant shape Elicium gives the convention centre a bold front design and provides the venue with a striking and flexible location for high profile international events.



 **SMART & HEALTHY**
CATERING
CONCEPT



2ND FLOOR ENTRANCE C

2ND/3RD/4TH/5TH FLOOR ELICIUM

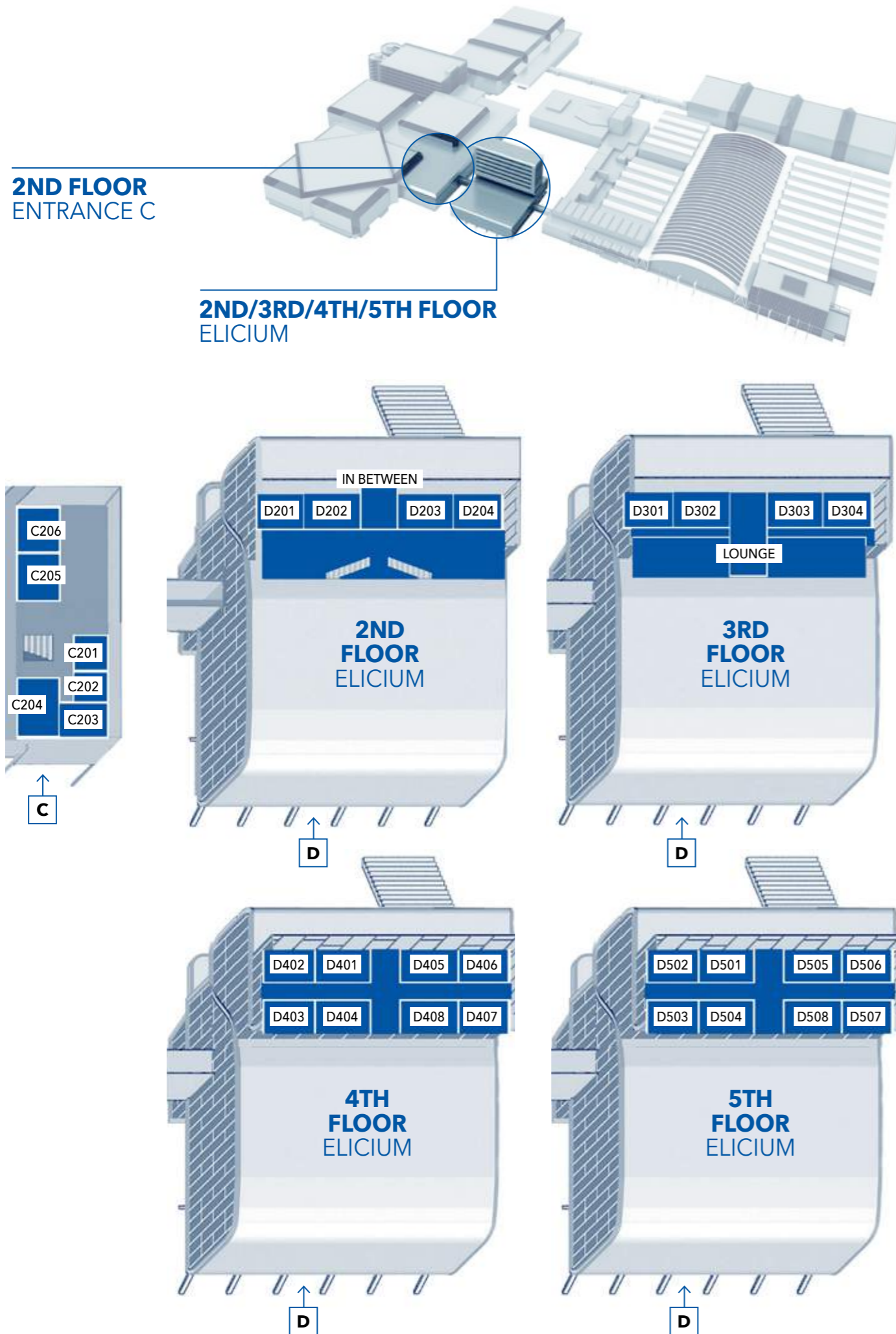

2ND FLOOR ENTRANCE C & 2ND/3RD/4TH/5TH FLOOR ELICIUM

ENTRANCE C	[M ²]	[Sqft]	⋮	⋮	⋮	⋮	⋮	⋮	⋮
C201*	48	517					14		•
C202*	45	484					14		•
C203*	75	807					20		•
C204*	58	624					18		•
C205**	34	366					8		
C206**	40	431					8		

ENTRANCE D - ELICIUM	[M ²]	[Sqft]	⋮	⋮	⋮	⋮	⋮	⋮	⋮
D201	105	1,130	94	30	42	22	28		•
D202	105	1,130	98	38	54	22	28		•
D201-D202 / D203-D204	210	2,260	198	72	126	54	60	104	•
D203	105	1,130	98	38	54	22	28		•
D204	105	1,130	94	30	42	22	28		•
D301	50	538	28	14	24	18	26		•
D302	40	431	20	10	18	10	18		•
D303	40	431	20	10	18	10	18		•
D304	50	538	28	14	24	18	26		•
D401	40	431	20	10	18	10	18		•
D402	50	538	28	14	24	18	26		•
D403	70	753	48	22	39	20	28		•
D404	50	538	35	18	30	16	22		•
D405	40	431	20	10	18	10	18		•
D406	50	538	28	14	24	18	26		•
D407	70	753	48	22	39	20	28		•
D408	50	538	35	18	30	16	22		•
D501*	40	431					11		•
D502	50	538	28	14	24	18	26		•
D503	70	753	48	22	39	20	28		•
D504	50	538	35	18	30	14	22		•
D505*	40	431					11		•
D506	50	538	28	14	24	18	26		•
D507	70	753	48	22	39	20	28		•
D508	50	538	35	18	30	16	22		•
In Between*	30	323					8		

Figures are guidelines, no rights can be derived from these figures. *Fixed Seating. **Only in combination with halls. • Available





Amtrium includes office spaces, conference rooms and a restaurant with rooftop terrace. A sustainable, multifunctional building, it also includes a greenhouse-like climate zone with plants.

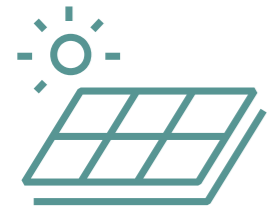

3969
SOLAR
PANELS



GROUND & 1ST FLOOR AMTRIUM 1 AND 2

GROUND FLOOR - AMTRIUM	[M ²]	[sqft]							
Amtrium 1	275	2,970	305	128	168	48	64		
Amtrium 2	265	2,852	270	128	168	46	60		
Amtrium 1+2	540	5,812	500	194	294	84	108		
Amtrium Lounge	600	6,458							•
Amtrium incl. Lounge	1,140	12,271							•

FIRST FLOOR - AMTRIUM	[M ²]	[sqft]							
L101	32	344	27	8	12	10	16		•
L102	31	333	27	8	12	10	16		•
L103	53	570	56	14	30	14	20		
L104	53	570	61	14	30	14	20		
L103-104	106	1,140	126	36	70	24	36		
Lounge L1	267	2,874							•

RESTAURANT	[M ²]	[sqft]							
Amtrium Restaurant	538	5,791						250	•

Figures are guidelines, no rights can be derived from these figures.

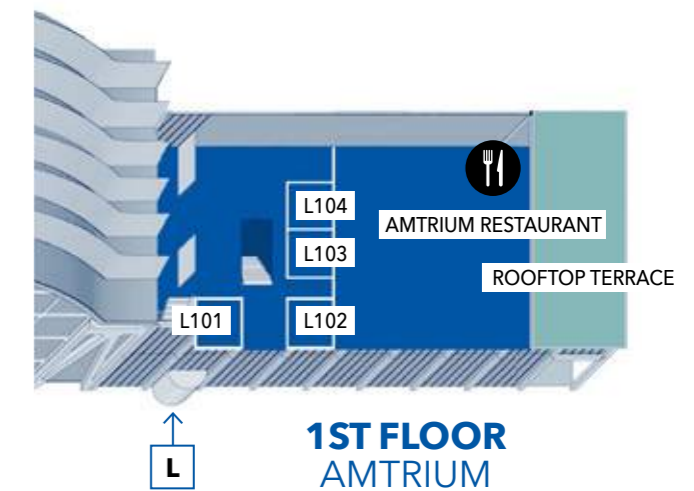
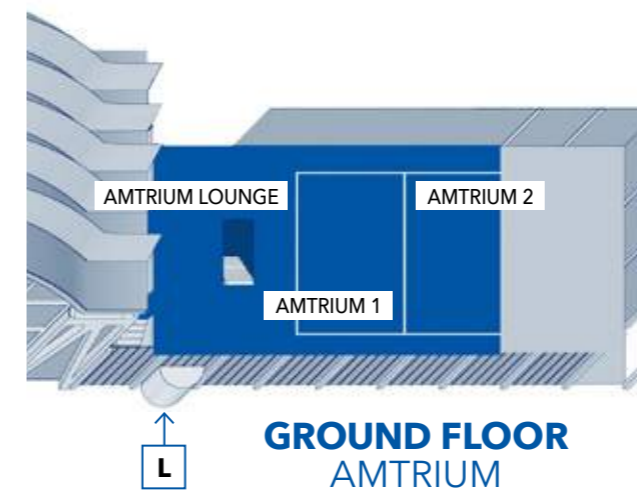



AN EXCELLENT CHOICE - MAKE YOURSELF AT HOME

Welcome to nhow Amsterdam RAI, a place where contemporary art, design, gastronomy and cultural expression come together. Located next to RAI Amsterdam, the building is a city landmark with its iconic architecture, 91 metres in height and its 650 rooms on 25 floors. All rooms have great views of the surrounding cityscape. The roof terrace on the 17th floor offers breathtaking panoramic views of Amsterdam. For (inter)national organisers, exhibitors and visitors this is the perfect home base.



The hotel boasts a
BREEAM Excellent
certification



MIXING BUSINESS WITH LEISURE

Let us take you on a tour of our venue to discover a hidden gem. Tucked away in a quiet spot just behind the RAI, you will find Strandzuid, an urban harbour and a genuine urban beach. The place consists of a restaurant and an amazing floating terrace on the water. The relaxed atmosphere makes it the ideal place to relax and have a drink... with your feet in the sand.



Strandzuid is
daily open for lunch,
drinks or dinner





**BEAUTIFULLY
LOCATED
IN AMSTERDAM**

RAI AMSTERDAM IS EASY ACCESSIBLE BY METRO, TRAM, TRAIN AND ROAD.

A direct train line connects Schiphol International Airport to RAI in just 15 minutes. From our doorstep, the metro will take you to the vibrant city centre in only 6 minutes. From Amsterdam Central Station you will enjoy the convenience of direct connections to and from every major European city. RAI Amsterdam is also ideally located for visiting by car, situated just off the A10 south ring road - exit 9 leads directly to our venue and our 4,500 car parking spaces.

Welcome home. Discover our house.

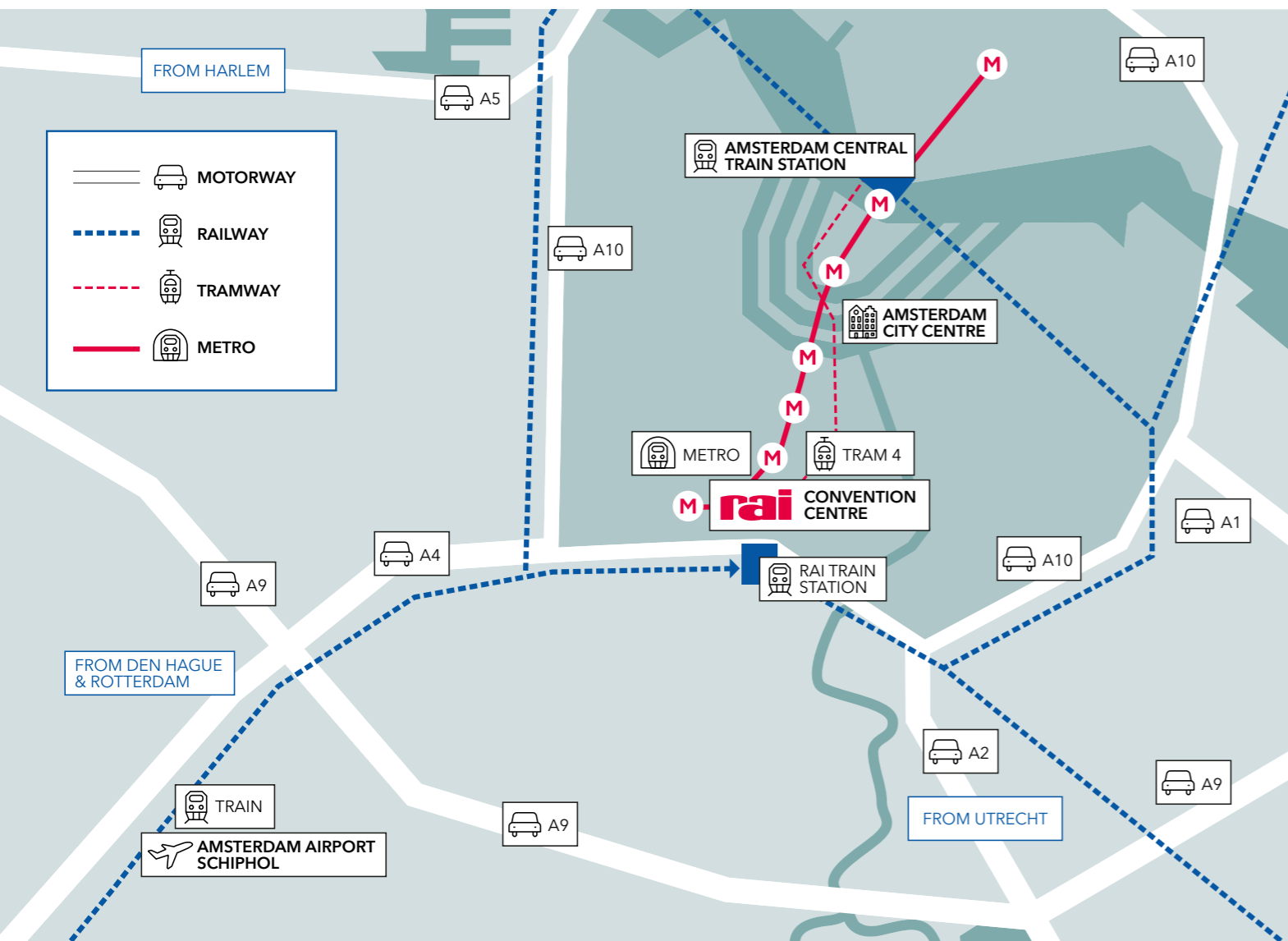

THIS BROCHURE IS PRINTED
ON RESPONSIBLE FSC PAPER

#04
/23

HOUSE OF EVENTS HOME OF YOUR INDUSTRY



rai
AMSTERDAM

Our house is your home
Please feel free to contact us at
+31 (0)20 549 17 22
raimarketing@rai.nl
www.rai.nl